

BRAND NEW MODERN APARTMENTS IN
NEAPOSIS AREA LIMASSOL

570 000 € —875 000 €

Property Code:	3106	Type:	Sale - Apartment
Location:	Limassol - NEAPOLIS	Renovation:	Modern
Number of floors:	4	Heating:	Underfloor heating
Energy class:	A	Distance to the sea:	100 m
Distance to airport:	60 km	Status:	New
VAT:	PLUS VAT		

Property features:

Unfurnished	Heating	Air Condition	Parking - Covered
Telephone Line	VRV central ceiling system	Store Room	Solar panels for hot water
Double Glazing	Garden	Balcony	

Description:

Neapolis Sea Front

A modern complex, located in the Neapolis Seafront area of Limassol, with liberally the sea front and Limassol promenade on your door step, being only 50 meters away. Modern design building using the latest architectural trends, top quality finishes and materials. Consists of six 2 & 3 bedroom apartments.

APARTMENT NO.	BEDROOMS	BATHROOMS	COVERED INDOOR AREA M ²	COVERED VERANDA AREA M2	STORE ROOM AREA M ²	COMMON AREA M ²	TOTAL COVERED AREA M ²	EURO PRICE € (BEFORE VAT)
101	3	2	105.50	26.50	3.00	10.00	145.00	€705,000
102	2	2	83.50	21.50	2.00	8.00	115.00	€570,000
201	3	2	105.50	29.00	3.00	10.00	147.50	€765,000
202	2	2	83.50	20.00	2.00	8.00	113.50	€600,000
301	3	2	105.50	29.00	3.00	10.00	147.50	€825,000
302	2	2	83.50	20.00	2.00	8.00	113.50	€640,000
401	3	2	105.50	30.00	5.00	10.00	150.50	€875,000
402	2	2	83.50	21.50	2.00	8.00	115.00	€680,000

OFF PLAN 15 MONTHS DELIVERY

at €570,000 + VAT

Contemporary Coastal Living

Located just 100 metres from the sea in the heart of Limassol. The Residence enjoys an incredible location. Just steps from beautiful sandy beaches and the best of what Limassol has to offer.

A stylish development comprising contemporary apartments of 2 & 3 bedrooms and an exclusive penthouse residence, in the heart of cosmopolitan town of Limassol. Various floor plans available to suit individual lifestyle requirements.

A Mediterranean Retreat

Limassol is a city that offers contemporary living, but still in touch with its heritage and still offers an authentic, relaxed Mediterranean Lifestyle.

Memorable Moments offers a superb base, with a wealth of cultural and recreational activities, that promise memorable moments and endless leisure time and convenience.

Stylish Living

The residences offer a contemporary finish, with open style floor plans, large double bedrooms, generously sized verandas, enabling indoor-outdoor living. All residences having two verandas each offering the perfect space to relax and absorb the energising sea air.

The view from the top

The Residence penthouse not only command the best views, but also enjoys generous living areas and airy design. Ideal for those that enjoy indoor/outdoor living, the open plan living/dining area opens onto a sizeable terrace, providing the perfect space for entertaining. The Luxe penthouse enjoys upgraded fittings and finishes, including a VRV system integrated climate control), marble floors and smart home automation, to name but a few.

**BRAND NEW MODERN APARTMENTS IN
NEAPOSIS AREA LIMASSOL**

570 000 € —875 000 €



BRAND NEW MODERN APARTMENTS IN NEAPOSIS AREA LIMASSOL

570 000 € —875 000 €



BRAND NEW MODERN APARTMENTS IN NEAPOSIS AREA LIMASSOL

570 000 € —875 000 €

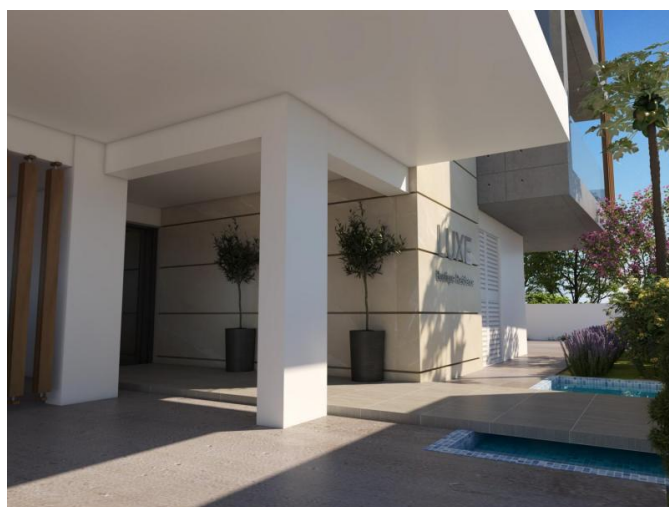

BRAND NEW MODERN APARTMENTS IN NEAPOSIS AREA LIMASSOL

570 000 € — 875 000 €

